

Solar / Eclipse Suspended

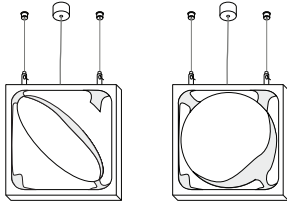

3000K: This product contains a light source of energy efficiency class D
 4000K: This product contains a light source of energy efficiency class C



Instructions

Place suspension wire-locks

- A. Disassemble ceiling fixation
- B. Mount top part to ceiling
- C. Pull steel wire trough bottom part
- D. Reassemble fixation with steel wire hanging out

Hang luminaire from wire locks

- E. Put wires into wire locks and adjust height by pushing in the wire-entrance

Connect power

- F. Dissassemble mounting box
- G. Fasten mounting piece with screws
- H. Fasten strain relief
- I. Place strain relief / connect 230V
- J. Assemble mounting box

Doxis Lighting Factory cannot be held responsible for damage caused by using the wrong driver.

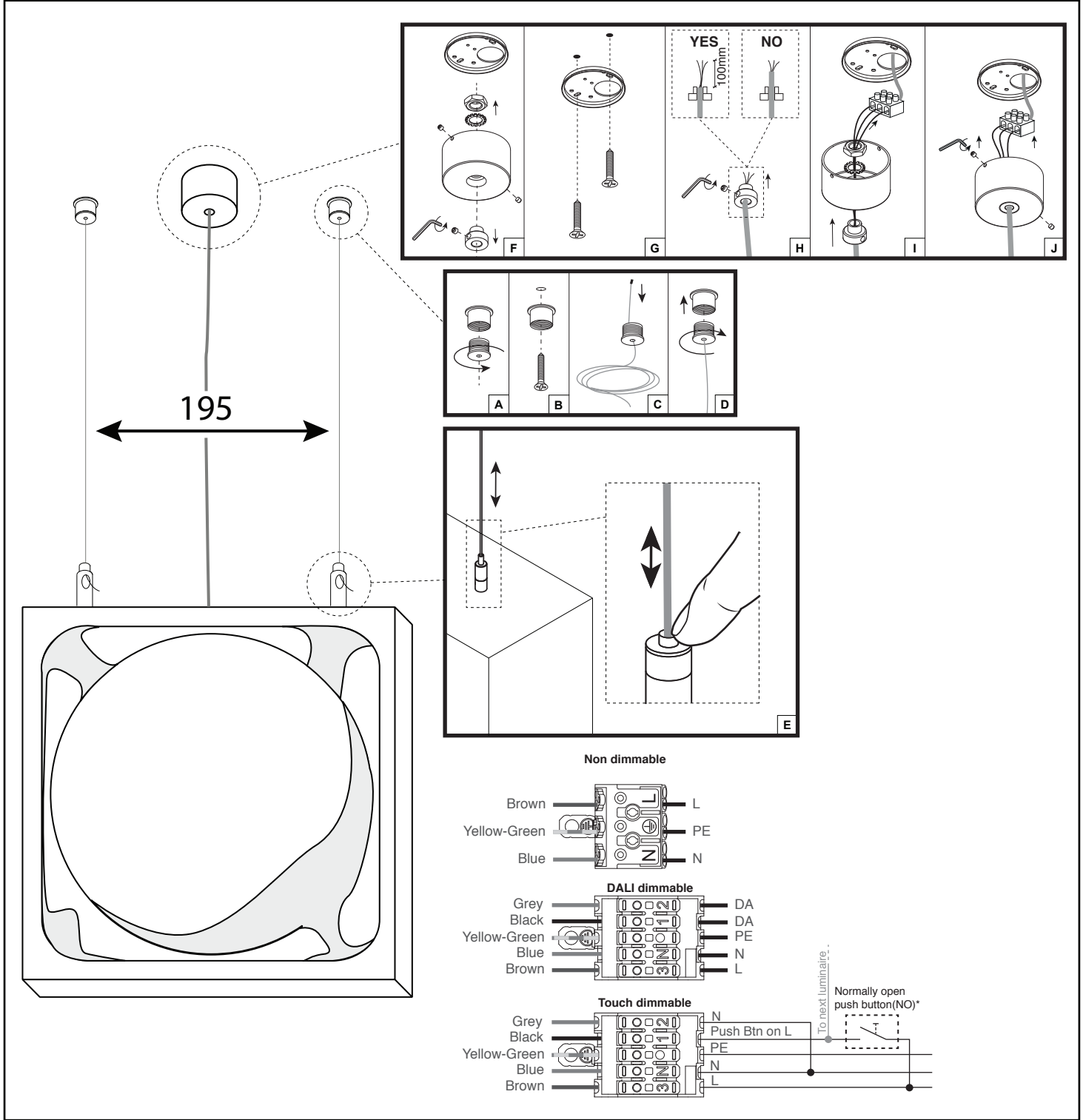

⚠ Attention!!

Always follow the instructions described in this document and store this document for future reference.

Do not touch LED surface. Warranty void if LED contact has taken place.
 Only to be installed by a qualified electrician.

Always make sure power is completely switched off when working on luminaire.

Doxis Lighting Factory NV cannot be held responsible for any damage caused by incorrect installation, modification, reparation or incorrect application/usage of the product.